

# SWEP B3H,B4M,B5H, B5TH,B5ASH

B3H	<b>Kaori</b>	B4M	<b>Kaori</b>	B5H	<b>Kaori</b>	B5TH	<b>Kaori</b>	B5ASH	<b>Kaori</b>
B3Hx10	<b>K010x8</b>	B4Mx10	<b>R020(1)Hx10</b>	B5Hx10	<b>K030(S)x10</b>	B5THx10	<b>K030(S)x10</b>	B5ASHx10	<b>K030(S)x10</b>
B3Hx12	<b>K010x10</b>	B4Mx16	<b>R020(1)Hx16</b>	B5Hx14	<b>K030(S)x14</b>	B5THx14	<b>K030(S)x14</b>	B5ASHx14	<b>K030(S)x14</b>
B3Hx14	<b>K010x12</b>	B4Mx22	<b>R020(1)Hx22</b>	B5Hx20	<b>K030(S)x20</b>	B5THx20	<b>K030(S)x20</b>	B5ASHx20	<b>K030(S)x20</b>
B3Hx16	<b>K010x14</b>	B4Mx28	<b>R020(1)Hx28</b>	B5Hx24	<b>K030(S)x24</b>	B5THx24	<b>K030(S)x24</b>	B5ASHx24	<b>K030(S)x24</b>
B3Hx20	<b>K010x16</b>	B4Mx34	<b>R020(1)Hx34</b>	B5Hx30	<b>K030(S)x30</b>	B5THx30	<b>K030(S)x30</b>	B5ASHx30	<b>K030(S)x30</b>
B3Hx24	<b>K010x20</b>	B4Mx40	<b>R020(1)Hx40</b>	B5Hx34	<b>K030(S)x34</b>	B5THx34	<b>K030(S)x34</b>	B5ASHx34	<b>K030(S)x34</b>
B3Hx26	<b>K010x22</b>	B4Mx44	<b>R020(1)Hx44</b>	B5Hx40	<b>K030(S)x40</b>	B5THx40	<b>K030(S)x40</b>	B5ASHx40	<b>K030(S)x40</b>
B3Hx28	<b>K010x24</b>	B4Mx48	<b>R020(1)Hx48</b>	B5Hx44	<b>K030(S)x44</b>	B5THx44	<b>K030(S)x44</b>	B5ASHx44	<b>K030(S)x44</b>
B3Hx30	<b>K010x26</b>	B4Mx52	<b>R020(1)Hx52</b>	B5Hx50	<b>K030(S)x50</b>	B5THx50	<b>K030(S)x50</b>	B5ASHx50	<b>K030(S)x50</b>
B3Hx34	<b>K010x28</b>	B4Mx56	<b>R020(1)Hx56</b>	B5Hx54	<b>K030(S)x54</b>	B5THx54	<b>K030(S)x54</b>	B5ASHx54	<b>K030(S)x54</b>
B3Hx36	<b>K010x30</b>	B4Mx60	<b>R020(1)Hx60</b>	B5Hx60	<b>K030(S)x60</b>	B5THx60	<b>K030(S)x60</b>	B5ASHx60	<b>K030(S)x60</b>
B3, L2=91, W=54.4, d=1.22 K010, L2=110, W=61, d=1.7 Max. Plate Number : 30 Max. Working Press. : K010 : 30 bar		B4M, L2=154, W=76, d=1.02 R020(1)H, L2=154, W=77, d=1.10 Max. Plate Number : 60 Max. Working Press. : R020H : 30 bar, R021H : 45 bar		B5H, L2=154, W=72, d=2.24 K030(S), L2=154, W=78, d=2.25 Max. Plate Number : 60 Max. Working Press. : K030 : 30 bar, K030S : 45 bar		B5TH, L2=154, W=72, d=2.24 K030(S), L2=154, W=78, d=2.25 Max. Plate Number : 60 Max. Working Press. : K030 : 30 bar, K030S : 45 bar		B5ASH, L2=154, W=76, d=2.24 K030(S), L2=154, W=78, d=2.25 Max. Plate Number : 60 Max. Working Press. : K030 : 30 bar, K030S : 45 bar	

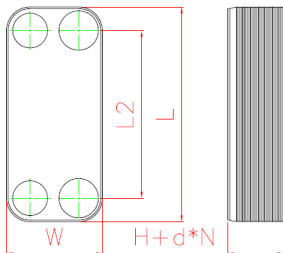

# SWEP B8H,B8TH,BX8TH, B8LASH

B8H	<b>Kaori</b>	B8TH	<b>Kaori</b>	BX8TH	<b>Kaori</b>	B8LASH	<b>Kaori</b>
B8Hx10	<b>K040(S)x10</b>	B8THx10	<b>K040(S)x10</b>	BX8THx10	<b>K040(S)x12</b>	B8LASHx10	<b>R040(1)x10</b>
B8Hx14	<b>K040(S)x14</b>	B8THx14	<b>K040(S)x14</b>	BX8THx14	<b>K040(S)x16</b>	B8LASHx14	<b>R040(1)x14</b>
B8Hx20	<b>K040(S)x20</b>	B8THx20	<b>K040(S)x20</b>	BX8THx20	<b>K040(S)x22</b>	B8LASHx20	<b>R040(1)x20</b>
B8Hx24	<b>K040(S)x24</b>	B8THx24	<b>K040(S)x24</b>	BX8THx24	<b>K040(S)x26</b>	B8LASHx24	<b>R040(1)x24</b>
B8Hx30	<b>K040(S)x30</b>	B8THx30	<b>K040(S)x30</b>	BX8THx30	<b>K040(S)x32</b>	B8LASHx30	<b>R040(1)x30</b>
B8Hx34	<b>K040(S)x34</b>	B8THx34	<b>K040(S)x34</b>	BX8THx34	<b>K040(S)x36</b>	B8LASHx34	<b>R040(1)x34</b>
B8Hx40	<b>K040(S)x40</b>	B8THx40	<b>K040(S)x40</b>	BX8THx40	<b>K040(S)x42</b>	B8LASHx40	<b>R040(1)x40</b>
B8Hx44	<b>K040(S)x44</b>	B8THx44	<b>K040(S)x44</b>	BX8THx44	<b>K040(S)x46</b>	B8LASHx44	<b>R040(1)x44</b>
B8Hx50	<b>K040(S)x50</b>	B8THx50	<b>K040(S)x50</b>	BX8THx50	<b>K040(S)x52</b>	B8LASHx50	<b>R040(1)x50</b>
B8Hx54	<b>K040(S)x54</b>	B8THx54	<b>K040(S)x54</b>	BX8THx54	<b>K040(S)x56</b>	B8LASHx54	<b>R040(1)x54</b>
B8Hx60	<b>K040(S)x60</b>	B8THx60	<b>K040(S)x60</b>	BX8THx58	<b>K040(S)x60</b>	B8LASHx60	<b>R040(1)x60</b>
B8H, L2=278, W=72, d=2.24 K040(S), L2=278, W=73, d=2.30 Max. Plate Number : 60 Max. Working Press. : K040 : 30 bar, K040S : 45 bar		B8TH, L2=278, W=72, d=2.24 K040(S), L2=278, W=73, d=2.30 Max. Plate Number : 60 Max. Working Press. : K040 : 30 bar, K040S : 45 bar		BX8TH, L2=278, W=73, d=2.24 K040(S), L2=278, W=73, d=2.30 Max. Plate Number : 60 Max. Working Press. : K040 : 30 bar, K040S : 45 bar		B8LASH, L2=278, W=76.2, d=1.32 R040(1), L2=278, W=73, d=1.30 Max. Plate Number : 60 Max. Working Press. :38 bar R040 : 30 bar, R041 : 45 bar	

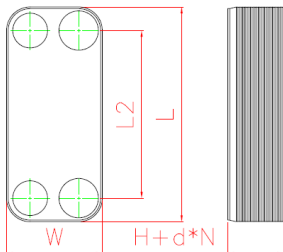

# SWEP B10H,B10TH, B12M, B15TH

B10H	<b>Kaori</b>	B10TH	<b>Kaori</b>	B12M	<b>Kaori</b>	B15TH	<b>Kaori</b>
B10Hx10	<b>K070(S)x10</b>	B10THx10	<b>K070(S)x10</b>	B12Mx10	<b>K050(S)Mx10</b>	B15THx10	<b>K060(S)Hx10</b>
B10Hx20	<b>K070(S)x20</b>	B10THx20	<b>K070(S)x20</b>	B12Mx20	<b>K050(S)Mx20</b>	B15THx14	<b>K060(S)Hx14</b>
B10Hx30	<b>K070(S)x30</b>	B10THx30	<b>K070(S)x30</b>	B12Mx30	<b>K050(S)Mx30</b>	B15THx20	<b>K060(S)Hx20</b>
B10Hx40	<b>K070(S)x40</b>	B10THx40	<b>K070(S)x40</b>	B12Mx40	<b>K050(S)Mx40</b>	B15THx24	<b>K060(S)Hx24</b>
B10Hx50	<b>K070(S)x50</b>	B10THx50	<b>K070(S)x50</b>	B12Mx50	<b>K050(S)Mx50</b>	B15THx30	<b>K060(S)Hx30</b>
B10Hx60	<b>K070(S)x60</b>	B10THx60	<b>K070(S)x60</b>	B12Mx60	<b>K050(S)Mx60</b>	B15THx34	<b>K060(S)Hx34</b>
B10Hx70	<b>K070(S)x70</b>	B10THx70	<b>K070(S)x70</b>	B12Mx80	<b>K050(S)Mx80</b>	B15THx40	<b>K060(S)Hx40</b>
B10Hx90	<b>K070(S)x90</b>	B10THx90	<b>K070(S)x90</b>	B12Mx90	<b>K050(S)Mx90</b>	B15THx44	<b>K060(S)Hx44</b>
B10Hx100	<b>K070(S)x100</b>	B10THx100	<b>K070(S)x100</b>	B12Mx100	<b>K050(S)Mx100</b>	B15THx50	<b>K060(S)Hx50</b>
B10Hx110	<b>K070(S)x110</b>	B10THx110	<b>K070(S)x110</b>	B12Mx110	<b>K050(S)Mx110</b>	B15THx54	<b>K060(S)Hx54</b>
B10Hx120	<b>K070(S)x120</b>	B10THx120	<b>K070(S)x120</b>	B12Mx120	<b>K050(S)Mx120</b>	B15THx60	<b>K060(S)Hx60</b>
B10H, L2=243, W=117, d=2.34 K070(S), L2=250, W=123, d=2.38 Max. Plate Number : 120 Max. Working Press. : K070 : 30 bar, K070S : 45 bar		B10TH, L2=243, W=117, d=2.34 K070(S), L2=250, W=123, d=2.38 Max. Plate Number : 120 Max. Working Press. : K070 : 30 bar, K070S : 45 bar		B12, L2=234, W=117, d=2.34 K050(S)M, L2=250, W=106, d=2.38 Max. Plate Number : 120 Max. Working Press. : K050M: 30 bar, K050SM : 45 bar		B15TH, L2=432, W=76, d=2.24 K060(S)H, L2=432, W=74, d=2.30 Max. Plate Number : 60 Max. Working Press. : K060 : 30 bar, K060SH : 45 bar	

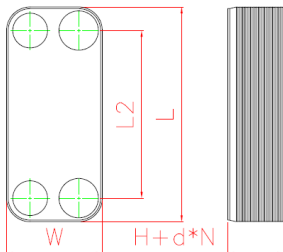

# SWEP B16H,B20H, B25H

B16H	Kaori	B20H	Kaori	B20H	Kaori	B25H	Kaori
B16Hx10	<b>K070(S)x12</b>	B20Hx10	<b>K035(S)x12</b>	B20Hx10	<b>R040(1)x10</b>	B25Hx10	<b>K095(S)x12</b>
B16Hx16	<b>K070(S)x18</b>	B20Hx14	<b>K035(S)x16</b>	B20Hx16	<b>R040(1)x18</b>	B25Hx14	<b>K095(S)x16</b>
B16Hx20	<b>K070(S)x24</b>	B20Hx18	<b>K035(S)x20</b>	B20Hx22	<b>R040(1)x24</b>	B25Hx20	<b>K095(S)x24</b>
B16Hx30	<b>K070(S)x36</b>	B20Hx22	<b>K035(S)x26</b>	B20Hx26	<b>R040(1)x30</b>	B25Hx24	<b>K095(S)x28</b>
B16Hx40	<b>K070(S)x48</b>	B20Hx26	<b>K035(S)x30</b>	B20Hx30	<b>R040(1)x34</b>	B25Hx30	<b>K095(S)x34</b>
B16Hx50	<b>K070(S)x60</b>	B20Hx30	<b>K035(S)x36</b>	B20Hx34	<b>R040(1)x38</b>	B25Hx40	<b>K095(S)x46</b>
B16Hx60	<b>K070(S)x86</b>	B20Hx34	<b>K035(S)x40</b>	B20Hx38	<b>R040(1)x44</b>	B25Hx50	<b>K095(S)x58</b>
B16Hx70	<b>K070(S)x62</b>	B20Hx38	<b>K035(S)x44</b>	B20Hx42	<b>R040(1)x48</b>	B25Hx60	<b>K095(S)x70</b>
B16Hx80	<b>K070(S)x98</b>	B20Hx42	<b>K035(S)x50</b>	B20Hx46	<b>R040(1)x52</b>	B25Hx70	<b>K095(S)x82</b>
B16Hx90	<b>K070(S)x110</b>	B20Hx46	<b>K035(S)x54</b>	B20Hx50	<b>R040(1)x56</b>	B25Hx80	<b>K095(S)x92</b>
B16Hx98	<b>K070(S)x120</b>	B20Hx50	<b>K035(S)x60</b>	B20Hx52	<b>R040(1)x60</b>	B25Hx90	<b>K095(S)x104</b>
B16H, L2=320, W=119, d=2.24 K070(S), L2=250, W=124, d=2.38 Max. Plate Number : 120 Max. Working Press. : K070 : 30 bar, K070S : 45 bar		B20H, L2=269, W=94 ,d=1.46 K035(S), L2=250, W=78, d=1.40 Max. Plate Number : 60 Max. Working Press. : K035 : 30 bar, K035S : 45 bar		B20H, L2=269, W=94 ,d=1.46 R041, L2=278, W=73, d=1.30 Max. Plate Number : 60 Max. Working Press. : R040 : 30 bar, R041 : 45 bar		B25H, L2=479, W=116, d=2.34 K095(S), L2=466, W=106, d=2.38 Max. Plate Number : 120 Max. Working Press. : K095 : 30 bar, K095S : 45 bar	

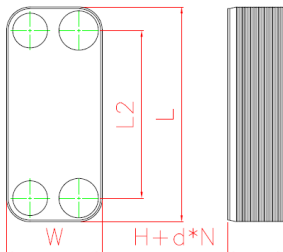

# SWEP B25H,B25TH,B26H

B25H	<b>Kaori</b>	B25TH	<b>Kaori</b>	B25TH	<b>Kaori</b>	B26H	<b>Kaori</b>
B25Hx10	<b>R095(6)Hx10</b>	B25THx10	<b>K095(S)x12</b>	B25THx10	<b>R095(6)Hx10</b>	B26Hx10	<b>R095(6)Hx8</b>
B25Hx20	<b>R095(6)Hx20</b>	B25THx14	<b>K095(S)x16</b>	B25THx20	<b>R095(6)Hx20</b>	B26Hx20	<b>R095(6)Hx16</b>
B25Hx30	<b>R095(6)Hx30</b>	B25THx20	<b>K095(S)x24</b>	B25THx30	<b>R095(6)Hx30</b>	B26Hx30	<b>R095(6)Hx24</b>
B25Hx40	<b>R095(6)Hx40</b>	B25THx24	<b>K095(S)x28</b>	B25THx40	<b>R095(6)Hx40</b>	B26Hx40	<b>R095(6)Hx32</b>
B25Hx50	<b>R095(6)Hx50</b>	B25THx30	<b>K095(S)x34</b>	B25THx50	<b>R095(6)Hx50</b>	B26Hx50	<b>R095(6)Hx40</b>
B25Hx60	<b>R095(6)Hx60</b>	B25THx40	<b>K095(S)x46</b>	B25THx60	<b>R095(6)Hx60</b>	B26Hx60	<b>R095(6)Hx48</b>
B25Hx80	<b>R095(6)Hx80</b>	B25THx50	<b>K095(S)x58</b>	B25THx80	<b>R095(6)Hx80</b>	B26Hx70	<b>R095(6)Hx56</b>
B25Hx90	<b>R095(6)Hx90</b>	B25THx60	<b>K095(S)x70</b>	B25THx90	<b>R095(6)Hx90</b>	B26Hx90	<b>R095(6)Hx72</b>
B25Hx100	<b>R095(6)Hx100</b>	B25THx70	<b>K095(S)x82</b>	B25THx100	<b>R095(6)Hx100</b>	B26Hx110	<b>R095(6)Hx88</b>
B25Hx110	<b>R095(6)Hx110</b>	B25THx80	<b>K095(S)x92</b>	B25THx110	<b>R095(6)Hx110</b>	B26Hx130	<b>R095(6)Hx104</b>
B25Hx120	<b>R095(6)Hx120</b>	B25THx90	<b>K095(S)x104</b>	B25THx120	<b>R095(6)Hx120</b>	B26Hx150	<b>R095(6)Hx120</b>
B25H, L2=479, W=116, d=2.34 R095(6)H, L2=466, W=106, d=1.85 Max. Plate Number : 120 Max. Working Press. : R095H : 30 bar, R096H : 45 bar		B25TH, L2=479, W=116, d=2.25 K095(S), L2=466, W=106, d=2.38 Max. Plate Number : 120 Max. Working Press. : K095 : 30 bar, K095S : 45 bar		B25TH, L2=479, W=116, d=2.25 R095(6)H, L2=466, W=106, d=1.85 Max. Plate Number : 120 Max. Working Press. : R095H : 30 bar, R096H : 45 bar		B26H, L2=329, W=119, d=1.63 R095(6)H, L2=466, W=106, d=1.85 Max. Plate Number : 120 Max. Working Press. : R095H : 30 bar, R096H : 45 bar	

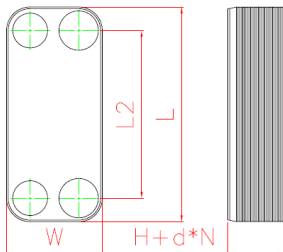

# SWEP B28H,B30L,B35

B28H	<b>Kaori</b>	B28H	<b>Kaori</b>	B30L	<b>Kaori</b>	B35	<b>Kaori</b>
B28Hx10	<b>K095(S)x12</b>	B28Hx10	<b>R095(6)Hx10</b>	B30Lx10	<b>Q085x10</b>	B35x10	<b>K205(S)x8</b>
B28Hx14	<b>K095(S)x16</b>	B28Hx20	<b>R095(6)Hx20</b>	B30Lx16	<b>Q085x16</b>	B35x30	<b>K205(S)x22</b>
B28Hx20	<b>K095(S)x24</b>	B28Hx30	<b>R095(6)Hx30</b>	B30Lx24	<b>Q085x24</b>	B35x50	<b>K205(S)x36</b>
B28Hx24	<b>K095(S)x28</b>	B28Hx40	<b>R095(6)Hx40</b>	B30Lx32	<b>Q085x32</b>	B35x80	<b>K205(S)x56</b>
B28Hx30	<b>K095(S)x34</b>	B28Hx50	<b>R095(6)Hx50</b>	B30Lx38	<b>Q085x38</b>	B35x110	<b>K205(S)x78</b>
B28Hx40	<b>K095(S)x46</b>	B28Hx60	<b>R095(6)Hx60</b>	B30Lx46	<b>Q085x46</b>	B35x130	<b>K205(S)x92</b>
B28Hx50	<b>K095(S)x58</b>	B28Hx80	<b>R095(6)Hx80</b>	B30Lx54	<b>Q085x54</b>	B35x150	<b>K205(S)x106</b>
B28Hx60	<b>K095(S)x68</b>	B28Hx90	<b>R095(6)Hx90</b>	B30Lx62	<b>Q085x62</b>	B35x170	<b>K205(S)x120</b>
B28Hx70	<b>K095(S)x80</b>	B28Hx100	<b>R095(6)Hx100</b>	B30Lx68	<b>Q085x68</b>	B35x200	<b>K205(S)x140</b>
B28Hx80	<b>K095(S)x92</b>	B28Hx110	<b>R095(6)Hx110</b>	B30Lx74	<b>Q085x74</b>	B35x230	<b>K205(S)x162</b>
B28Hx90	<b>K095(S)x102</b>	B28Hx120	<b>R095(6)Hx120</b>	B30Lx80	<b>Q085x80</b>	B35x250	<b>K205(S)x176</b>
B28H, L2=470, W=119, d=2.24 K095(S), L2=466, W=106, d=2.38 Max. Plate Number : 140 Max. Working Press. : K095 : 30 bar, K095S : 45 bar		B28H, L2=470, W=119, d=2.24 R095H, L2=466, W=106, d=1.85 Max. Plate Number : 120 Max. Working Press. : R095H : 30 bar, R096H : 45 bar		B30L, L2=173.7, W=243.5, d=2.12 Q085, L2=240, W=189, d=2.4 Max. Plate Number : 80 Max. Working Press. : Q085 : 30 bar		B35, L2=324, W=243, d=2.34 K205(S), L2=456, W=246, d=2.40 Max. Plate Number : 220 Max. Working Press. : < 30 bar K205 : 30 bar, K205S : 45 bar	

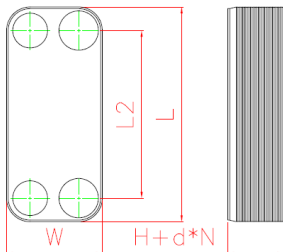

# SWEP B35T,B45,B56H,B60H

B35T	Kaori	B45	Kaori	B56H	Kaori	B60H	Kaori
B35Tx10	<b>K205(S)x8</b>	B45x20	<b>K205(S)x20</b>	B56Hx20	<b>K205(S)x18</b>	B60Hx20	<b>K205(S)x20</b>
B35Tx30	<b>K205(S)x22</b>	B45x30	<b>K205(S)x30</b>	B56Hx40	<b>K205(S)x36</b>	B60Hx30	<b>K205(S)x30</b>
B35Tx50	<b>K205(S)x36</b>	B45x40	<b>K205(S)x40</b>	B56Hx60	<b>K205(S)x56</b>	B60Hx40	<b>K205(S)x40</b>
B35Tx80	<b>K205(S)x56</b>	B45x60	<b>K205(S)x60</b>	B56Hx90	<b>K205(S)x84</b>	B60Hx60	<b>K205(S)x60</b>
B35Tx110	<b>K205(S)x78</b>	B45x90	<b>K205(S)x90</b>	B56Hx110	<b>K205(S)x102</b>	B60Hx90	<b>K205(S)x90</b>
B35Tx130	<b>K205(S)x92</b>	B45x110	<b>K205(S)x110</b>	B56Hx130	<b>K205(S)x120</b>	B60Hx110	<b>K205(S)x110</b>
B35Tx150	<b>K205(S)x106</b>	B45x140	<b>K205(S)x140</b>	B56Hx150	<b>K205(S)x140</b>	B60Hx140	<b>K205(S)x140</b>
B35Tx170	<b>K205(S)x120</b>	B45x160	<b>K205(S)x160</b>	B56Hx170	<b>K205(S)x158</b>	B60Hx160	<b>K205(S)x160</b>
B35Tx200	<b>K205(S)x140</b>	B45x180	<b>K205(S)x180</b>	B56Hx190	<b>K205(S)x176</b>	B60Hx180	<b>K205(S)x180</b>
B35Tx230	<b>K205(S)x162</b>	B45x200	<b>K205(S)x200</b>	B56Hx210	<b>K205(S)x194</b>	B60Hx200	<b>K205(S)x200</b>
B35Tx250	<b>K205(S)x176</b>	B45x220	<b>K205(S)x220</b>	B56Hx236	<b>K205(S)x220</b>	B60Hx220	<b>K205(S)x220</b>
B35T, L2=324, W=243, d=2.26 K205(S), L2=456, W=245, d=2.40 Max. Plate Number : 220 Max. Working Press. : K205 : 30 bar, K205S : 45 bar		B45, L2=456, W=243, d=2.34 K205(S), L2=456, W=246, d=2.40 Max. Plate Number : 220 Max. Working Press. : K205 : 30 bar, K205S : 45 bar		B56H, L2=430, W=243, d=2.44 K205(S), L2=456, W=246, d=2.40 Max. Plate Number : 220 Max. Working Press. : K205 : 30 bar, K205S : 45 bar		B60H, L2=284.5, W=364, d=2.14 K205(S), L2=456, W=246, d=2.40 Max. Plate Number : 220 Max. Working Press. : K205 : 30 bar, K205S : 45 bar	

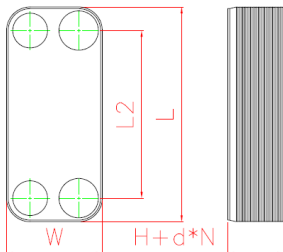

# SWEP B65H,B80H,B80ASH

B65H	<b>Kaori</b>	B80H	<b>Kaori</b>	B80H	<b>Kaori</b>	B80ASH	<b>Kaori</b>
B65Hx20	<b>Z600(1)Hx18</b>	B80x10	<b>K095(S)x12</b>	B80Hx10	<b>R095(6)x10</b>	B80ASHx10	<b>R095(6)Hx10</b>
B65Hx40	<b>Z600(1)Hx34</b>	B80x14	<b>K095(S)x16</b>	B80Hx20	<b>R095(6)x20</b>	B80ASHx20	<b>R095(6)Hx20</b>
B65Hx60	<b>Z600(1)Hx52</b>	B80x20	<b>K095(S)x24</b>	B80Hx30	<b>R095(6)x30</b>	B80ASHx30	<b>R095(6)Hx30</b>
B65Hx90	<b>Z600(1)Hx78</b>	B80x24	<b>K095(S)x28</b>	B80Hx40	<b>R095(6)x40</b>	B80ASHx40	<b>R095(6)Hx40</b>
B65Hx110	<b>Z600(1)Hx96</b>	B80x30	<b>K095(S)x34</b>	B80Hx50	<b>R095(6)x50</b>	B80ASHx50	<b>R095(6)Hx50</b>
B65Hx130	<b>Z600(1)Hx114</b>	B80x40	<b>K095(S)x46</b>	B80Hx60	<b>R095(6)x60</b>	B80ASHx60	<b>R095(6)Hx60</b>
B65Hx160	<b>Z600(1)Hx140</b>	B80x50	<b>K095(S)x58</b>	B80Hx80	<b>R095(6)x80</b>	B80ASHx80	<b>R095(6)Hx80</b>
B65Hx190	<b>Z600(1)Hx166</b>	B80x60	<b>K095(S)x68</b>	B80Hx90	<b>R095(6)x90</b>	B80ASHx90	<b>R095(6)Hx90</b>
B65Hx220	<b>Z600(1)Hx192</b>	B80x70	<b>K095(S)x80</b>	B80Hx100	<b>R095(6)x100</b>	B80ASHx100	<b>R095(6)Hx100</b>
B65Hx250	<b>Z600(1)Hx218</b>	B80x80	<b>K095(S)x92</b>	B80Hx110	<b>R095(6)x110</b>	B80ASHx110	<b>R095(6)Hx110</b>
B65Hx280	<b>Z600(1)Hx244</b>	B80x90	<b>K095(S)x102</b>	B80Hx120	<b>R095(6)x120</b>	B80ASHx120	<b>R095(6)Hx120</b>
B65H, L2=731, W=363, d=2.32 Z600(1)H, L2=810, W=375, d=2.38 Max. Plate Number : 250 Max. Working Press. : 29 bar Z600H : 30 bar, Z601H : 45 bar		B80H, L2=470, W=119, d=2.24 K095(S), L2=466, W=106, d=2.40 Max. Plate Number : 120 Max. Working Press. : K095 : 30 bar, K095S : 45 bar		B80ASH, L2=470, W=119, d=2.24 R095(6), L2=466, W=106, d=1.85 Max. Plate Number : 120 Max. Working Press. : R095H : 30 bar, R096H : 45 bar		B80ASH, L2=470, W=119, d=2.25 R095(6)H, L2=466, W=106, d=1.85 Max. Plate Number : 120 Max. Working Press. : R095H : 30 bar, R096H : 45 bar	

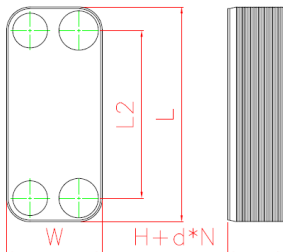



# SWEP B85H, B86H, B120TH, B200H

B85H	<b>Kaori</b>	B86H	<b>Kaori</b>	B120TH	<b>Kaori</b>	B200H	<b>Kaori</b>
B85Hx10	<b>R095(6)Hx10</b>	B86Hx10	<b>R095(6)Hx10</b>	B120THx20	<b>K205(S)x20</b>	B200Hx20	<b>K205(S)x20</b>
B85Hx14	<b>R095(6)Hx16</b>	B86Hx14	<b>R095(6)Hx16</b>	B120THx40	<b>K205(S)x40</b>	B200Hx40	<b>K205(S)x40</b>
B85Hx20	<b>R095(6)Hx22</b>	B86Hx20	<b>R095(6)Hx22</b>	B120THx60	<b>K205(S)x60</b>	B200Hx60	<b>K205(S)x60</b>
B85Hx30	<b>R095(6)Hx34</b>	B86Hx30	<b>R095(6)Hx34</b>	B120THx80	<b>K205(S)x80</b>	B200Hx80	<b>K205(S)x80</b>
B85Hx40	<b>R095(6)Hx44</b>	B86Hx40	<b>R095(6)Hx44</b>	B120THx100	<b>K205(S)x100</b>	B200Hx100	<b>K205(S)x100</b>
B85Hx50	<b>R095(6)Hx56</b>	B86Hx50	<b>R095(6)Hx56</b>	B120THx120	<b>K205(S)x120</b>	B200Hx120	<b>K205(S)x120</b>
B85Hx60	<b>R095(6)Hx68</b>	B86Hx60	<b>R095(6)Hx68</b>	B120THx140	<b>K205(S)x140</b>	B200Hx140	<b>K205(S)x140</b>
B85Hx70	<b>R095(6)Hx78</b>	B86Hx70	<b>R095(6)Hx78</b>	B120THx160	<b>K205(S)x160</b>	B200Hx160	<b>K205(S)x160</b>
B85Hx80	<b>R095(6)Hx90</b>	B86Hx80	<b>R095(6)Hx90</b>	B120THx180	<b>K205(S)x180</b>	B200Hx180	<b>K205(S)x180</b>
B85Hx90	<b>R095(6)Hx100</b>	B86Hx90	<b>R095(6)Hx100</b>	B120THx200	<b>K205(S)x200</b>	B200Hx200	<b>K205(S)x200</b>
B85Hx100	<b>R095(6)Hx112</b>	B86Hx100	<b>R095(6)Hx112</b>	B120THx220	<b>K205(S)x220</b>	B200Hx220	<b>K205(S)x220</b>
B85H, L2=470, W=119, d=1.84 R095(6)H, L2=466, W=106, d=1.85 Max. Plate Number : 120 Max. Working Press. : R095H : 30 bar, R096H : 45 bar		B86H, L2=470, W=119, d=1.68 R095(6)H, L2=466, W=106, d=1.85 Max. Plate Number : 120 Max. Working Press. : R095H : 30 bar, R096H : 45 bar		B120, L2=456, W=243, d=2.29 K205(S), L2=456, W=246, d=2.40 Max. Plate Number : 220 Max. Working Press. : K205 : 30 bar, K205S : 45 bar		B200H, L2=450, W=243, d=2.34 K205(S), L2=456, W=246, d=2.40 Max. Plate Number : 220 Max. Working Press. : K205 : 30 bar, K205S : 45 bar	

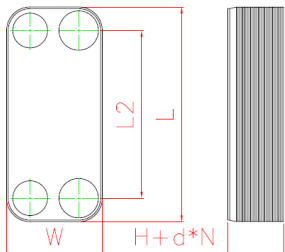

# SWEP B200TH,B250ASH,B320HTH,B320LTH

B200TH	<b>Kaori</b>	B250ASH	<b>Kaori</b>	B320HTH	<b>Kaori</b>	B320LTH	<b>Kaori</b>
B200THx20	<b>K205(S)x20</b>	B250ASHx20	<b>K200(S)Hx24</b>	B320HTHx20	<b>K205(S)x20</b>	B320LTHx20	<b>K210Sx20</b>
B200THx40	<b>K205(S)x40</b>	B250ASHx30	<b>K200SHx36</b>	B320HTHx40	<b>K205(S)x40</b>	B320LTHx40	<b>K210Sx40</b>
B200THx60	<b>K205(S)x60</b>	B250ASHx50	<b>K200(S)Hx60</b>	B320HTHx50	<b>K205(S)x50</b>	B320LTHx60	<b>K210Sx60</b>
B200THx80	<b>K205(S)x80</b>	B250ASHx60	<b>K200(S)Hx72</b>	B320HTHx70	<b>K205(S)x72</b>	B320LTHx80	<b>K210Sx80</b>
B200THx100	<b>K205(S)x100</b>	B250ASHx70	<b>K200(S)Hx84</b>	B320HTHx90	<b>K205(S)x92</b>	B320LTHx100	<b>K210Sx100</b>
B200THx120	<b>K205(S)x120</b>	B250ASHx80	<b>K200(S)Hx96</b>	B320HTHx110	<b>K205(S)x112</b>	B320LTHx120	<b>K210Sx120</b>
B200THx140	<b>K205(S)x140</b>	B250ASHx100	<b>K200(S)Hx120</b>	B320HTHx130	<b>K205(S)x134</b>	B320LTHx140	<b>K210Sx140</b>
B200THx160	<b>K205(S)x160</b>	B250ASHx120	<b>K200(S)Hx144</b>	B320HTHx150	<b>K205(S)x154</b>	B320LTHx160	<b>K210Sx160</b>
B200THx180	<b>K205(S)x180</b>	B250ASHx150	<b>K200(S)Hx182</b>	B320HTHx170	<b>K205(S)x174</b>	B320LTHx180	<b>K210Sx180</b>
B200THx200	<b>K205(S)x200</b>	B250ASHx160	<b>K200(S)Hx194</b>	B320HTHx190	<b>K205(S)x194</b>	B320LTHx200	<b>K210Sx200</b>
B200THx220	<b>K205(S)x220</b>	B250ASHx180	<b>K200(S)Hx218</b>	B320HTHx210	<b>K205(S)x216</b>	B320LTHx220	<b>K210Sx220</b>
B200TH, L2=450, W=243, d=2.29 K205(S), L2=456, W=246, d=2.40 Max. Plate Number : 220 Max. Working Press. : K205 : 30 bar, K205S : 45 bar		B250ASH, L2=538, W=202, d=1.91 K200(S)H, L2=519, W=186, d=2.40 Max. Plate Number : 220 Max. Working Press. : 38 bar K200H : 30 bar, K200SH : 45 bar		B320HTH, L2=441, W=243, d=1.98 K205(S), L2=456, W=245, d=2.40 Max. Plate Number : 220 Max. Working Press. : K205 : 30 bar, K205S : 45 bar		B320LTH, L2=430, W=243, d=2.57 K210S, L2=430, W=245, d=2.85 Max. Plate Number : 220 Max. Working Press. : K210S : 30 bar	

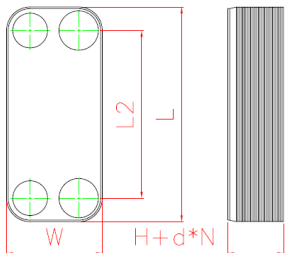

# SWEP B400H,B400TH,B427H,B439M

B400H	<b>Kaori</b>	B400TH	<b>Kaori</b>	B427H	<b>Kaori</b>	B439M	<b>Kaori</b>
B400Hx20	<b>Z400(1)Hx18</b>	B400THx20	<b>Z400(1)Hx18</b>	B427Hx20	<b>Z400(1)Hx16</b>	B439Mx20	<b>Z400(1)Mx24</b>
B400Hx40	<b>Z400(1)Hx34</b>	B400THx40	<b>Z400(1)Hx34</b>	B427Hx40	<b>Z400(1)Hx34</b>	B439Mx30	<b>Z400(1)Mx36</b>
B400Hx70	<b>Z400(1)Hx62</b>	B400THx70	<b>Z400(1)Hx62</b>	B427Hx60	<b>Z400(1)Hx50</b>	B439Mx40	<b>Z400(1)Mx48</b>
B400Hx100	<b>Z400(1)Hx88</b>	B400THx100	<b>Z400(1)Hx88</b>	B427Hx90	<b>Z400(1)Hx74</b>	B439Mx60	<b>Z400(1)Mx74</b>
B400Hx130	<b>Z400(1)Hx114</b>	B400THx130	<b>Z400(1)Hx114</b>	B427Hx120	<b>Z400(1)Hx100</b>	B439Mx80	<b>Z400(1)Mx98</b>
B400Hx150	<b>Z400(1)Hx132</b>	B400THx150	<b>Z400(1)Hx132</b>	B427Hx150	<b>Z400(1)Hx124</b>	B439Mx100	<b>Z400(1)Mx124</b>
B400Hx170	<b>Z400(1)Hx150</b>	B400THx170	<b>Z400(1)Hx150</b>	B427Hx180	<b>Z400(1)Hx150</b>	B439Mx120	<b>Z400(1)Mx148</b>
B400Hx190	<b>Z400(1)Hx166</b>	B400THx190	<b>Z400(1)Hx166</b>	B427Hx210	<b>Z400(1)Hx174</b>	B439Mx140	<b>Z400(1)Mx174</b>
B400Hx210	<b>Z400(1)Hx184</b>	B400THx210	<b>Z400(1)Hx184</b>	B427Hx240	<b>Z400(1)Hx200</b>	B439Mx160	<b>Z400(1)Mx198</b>
B400Hx230	<b>Z400(1)Hx202</b>	B400THx230	<b>Z400(1)Hx202</b>	B427Hx270	<b>Z400(1)Hx224</b>	B439Mx180	<b>Z400(1)Mx222</b>
B400Hx250	<b>Z400(1)Hx220</b>	B400THx250	<b>Z400(1)Hx220</b>	B427Hx300	<b>Z400(1)Hx248</b>	B439Mx200	<b>Z400(1)Mx248</b>
B400H, L2=601, W=304, d=2.34 Z400(1)H, L2=650, W=321, d=2.38 Max. Plate Number : 220 Max. Working Press. : Z400H : 30 bar, Z401H : 45 bar		B400TH, L2=601, W=304, d=2.29 Z400(1)H, L2=650, W=321, d=2.38 Max. Plate Number : 220 Z400H : 30 bar, Z401H : 45 bar		B427H, L2=567, W=304, d=2.29 Z400(1)H, L2=650, W=321, d=2.38 Max. Plate Number : 250 Z400H : 30 bar, Z401H : 45 bar		B439M, L2=854, W=304, d=2.29 Z400(1)M, L2=650, W=321, d=2.38 Max. Plate Number : 250 Z400M : 30 bar, Z401M : 45 bar	

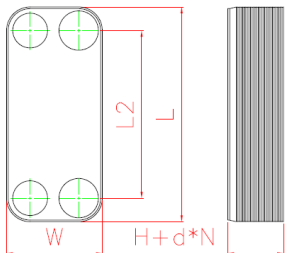

# SWEP B439M, B500TM, B633L

B439M	<b>Kaori</b>	B500TM	<b>Kaori</b>	B500TM	<b>Kaori</b>	B633L	<b>Kaori</b>
B439Mx20	<b>Z600(1)Mx16</b>	B500TMx20	<b>Z400(1)Mx24</b>	B500TMx20	<b>Z600(1)Mx16</b>	B633Lx20	<b>Z600(1)Lx20</b>
B439Mx40	<b>Z600(1)Mx34</b>	B500TMx30	<b>Z400(1)Mx36</b>	B500TMx40	<b>Z600(1)Mx34</b>	B633Lx40	<b>Z600(1)Lx40</b>
B439Mx60	<b>Z600(1)Mx52</b>	B500TMx40	<b>Z400(1)Mx48</b>	B500TMx60	<b>Z600(1)Mx52</b>	B633Lx60	<b>Z600(1)Lx60</b>
B439Mx80	<b>Z600(1)Mx68</b>	B500TMx60	<b>Z400(1)Mx74</b>	B500TMx80	<b>Z600(1)Mx68</b>	B633Lx80	<b>Z600(1)Lx80</b>
B439Mx110	<b>Z600(1)Mx94</b>	B500TMx80	<b>Z400(1)Mx98</b>	B500TMx110	<b>Z600(1)Mx94</b>	B633Lx110	<b>Z600(1)Lx110</b>
B439Mx140	<b>Z600(1)Mx120</b>	B500TMx100	<b>Z400(1)Mx124</b>	B500TMx140	<b>Z600(1)Mx120</b>	B633Lx150	<b>Z600(1)Lx150</b>
B439Mx170	<b>Z600(1)Mx146</b>	B500TMx120	<b>Z400(1)Mx148</b>	B500TMx170	<b>Z600(1)Mx146</b>	B633Lx170	<b>Z600(1)Lx170</b>
B439Mx200	<b>Z600(1)Mx170</b>	B500TMx140	<b>Z400(1)Mx174</b>	B500TMx200	<b>Z600(1)Mx170</b>	B633Lx190	<b>Z600(1)Lx190</b>
B439Mx230	<b>Z600(1)Mx196</b>	B500TMx160	<b>Z400(1)Mx198</b>	B500TMx230	<b>Z600(1)Mx196</b>	B633Lx210	<b>Z600(1)Lx210</b>
B439Mx260	<b>Z600(1)Mx222</b>	B500TMx180	<b>Z400(1)Mx222</b>	B500TMx260	<b>Z600(1)Mx222</b>	B633Lx230	<b>Z600(1)Lx230</b>
B439Mx290	<b>Z600(1)Mx248</b>	B500TMx200	<b>Z400(1)Mx248</b>	B500TMx290	<b>Z600(1)Mx248</b>	B633Lx250	<b>Z600(1)Lx250</b>
B439M, L2=854, W=304, d=2.29 Z600(1)M, L2=810, W=375, d=2.38 Max. Plate Number : 250 Z600M : 30 bar, Z601M : 45 bar		B500TM, L2=854, W=304, d=2.29 Z400(1)M, L2=650, W=321, d=2.38 Max. Plate Number : 250 Max. Working Press. : Z400M : 30 bar, Z401M : 45 bar		B500TM, L2=854, W=304, d=2.29 Z600(1)M, L2=810, W=375, d=2.38 Max. Plate Number : 250 Max. Working Press. : Z600M : 30 bar, Z601M : 45 bar		B633L, L2=593, W=537, d=2.39 Z600(1)L, L2=810, W=375, d=2.38 Max. Plate Number : 250 Max. Working Press. : Z600L : 30 bar, Z601L : 45 bar	

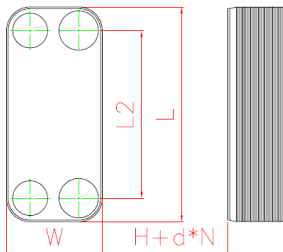

# SWEP P80H, P80ASH, P120TH, P250ASH

P80H	<b>Kaori</b>	P80ASH	<b>Kaori</b>	P120TH	<b>Kaori</b>	P250ASH	<b>Kaori</b>
P80Hx10	<b>R095(6)Hx10</b>	P80ASHx10	<b>R095(6)Hx10</b>	P120THx20	<b>K205(S)x20</b>	P250ASHx20	<b>K200(S)Hx24</b>
P80Hx20	<b>R095(6)Hx20</b>	P80ASHx20	<b>R095(6)Hx20</b>	P120THx40	<b>K205(S)x40</b>	P250ASHx30	<b>K200(S)Hx36</b>
P80Hx30	<b>R095(6)Hx30</b>	P80ASHx30	<b>R095(6)Hx30</b>	P120THx60	<b>K205(S)x60</b>	P250ASHx50	<b>K200(S)Hx60</b>
P80Hx40	<b>R095(6)Hx40</b>	P80ASHx40	<b>R095(6)Hx40</b>	P120THx80	<b>K205(S)x80</b>	P250ASHx60	<b>K200(S)Hx72</b>
P80Hx50	<b>R095(6)Hx50</b>	P80ASHx50	<b>R095(6)Hx50</b>	P120THx100	<b>K205(S)x100</b>	P250ASHx70	<b>K200(S)Hx84</b>
P80Hx60	<b>R095(6)Hx60</b>	P80ASHx60	<b>R095(6)Hx60</b>	P120THx120	<b>K205(S)x120</b>	P250ASHx80	<b>K200(S)Hx96</b>
P80Hx80	<b>R095(6)Hx80</b>	P80ASHx80	<b>R095(6)Hx80</b>	P120THx140	<b>K205(S)x140</b>	P250ASHx100	<b>K200(S)Hx120</b>
P80Hx90	<b>R095(6)Hx90</b>	P80ASHx90	<b>R095(6)Hx90</b>	P120THx160	<b>K205(S)x160</b>	P250ASHx120	<b>K200(S)Hx144</b>
P80Hx100	<b>R095(6)Hx100</b>	P80ASHx100	<b>R095(6)Hx100</b>	P120THx180	<b>K205(S)x180</b>	P250ASHx150	<b>K200(S)Hx182</b>
P80Hx110	<b>R095(6)Hx110</b>	P80ASHx110	<b>R095(6)Hx110</b>	P120THx200	<b>K205(S)x200</b>	P250ASHx160	<b>K200(S)Hx194</b>
P80Hx120	<b>R095(6)Hx120</b>	P80ASHx120	<b>R095(6)Hx120</b>	P120THx220	<b>K205(S)x220</b>	P250ASHx180	<b>K200(S)Hx218</b>
P80H, L2=470, W=119, d=2.24 R095(6)H, L2=466, W=106, d=1.85 Max. Plate Number : 120 Max. Working Press. : R095H : 30 bar, R096H : 45 bar		P80ASH, L2=470, W=119, d=2.25 R095(6)H, L2=466, W=106, d=1.85 Max. Plate Number : 120 Max. Working Press. : R095H : 30 bar, R096H : 45 bar		P120TH, L2=456, W=243, d=2.29 K205(S), L2=456, W=246, d=2.40 Max. Plate Number : 220 Max. Working Press. : K205 : 30 bar, K205S : 45 bar		P250ASH, L2=538, W=202, d=1.91 K200(S)H, L2=519, W=186, d=2.40 Max. Plate Number : 220 Max. Working Press. : Side 1 : 46 bar Side 2 : 28 bar	

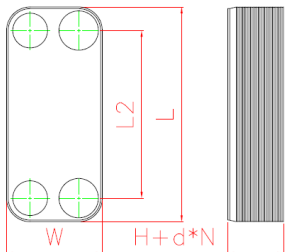

# SWEP P400TH

P400TH	<b>Kaori</b>						
P400THx20	<b>Z400(1)Hx18</b>						
P400THx40	<b>Z400(1)Hx34</b>						
P400THx70	<b>Z400(1)Hx62</b>						
P400THx100	<b>Z400(1)Hx88</b>						
P400THx130	<b>Z400(1)Hx114</b>						
P400THx150	<b>Z400(1)Hx132</b>						
P400THx170	<b>Z400(1)Hx150</b>						
P400THx190	<b>Z400(1)Hx166</b>						
P400THx210	<b>Z400(1)Hx184</b>						
P400THx230	<b>Z400(1)Hx202</b>						
P400THx250	<b>Z400(1)Hx220</b>						
P400TH, L2=601, W=304, d=2.29 Z400(1)H, L2=650, W=321, d=2.38 Max. Plate Number : 250 Z400H : 30 bar, Z401H : 45 bar							

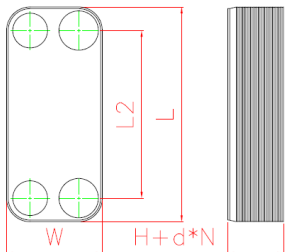

# SWEP DBD47, DBD58, DBD200H

DBD47	<b>Kaori</b>	DBD58	<b>Kaori</b>	DBD200H	<b>Kaori</b>
DBD47x18	<b>K215(S)Dx18</b>	DBD58x22	<b>Z415(6)x18</b>	DBD200Hx18	<b>K215(S)Dx18</b>
DBD47x30	<b>K215(S)Dx30</b>	DBD58x46	<b>Z415(6)x36</b>	DBD200Hx30	<b>K215(S)Dx30</b>
DBD47x42	<b>K215(S)Dx42</b>	DBD58x66	<b>Z415(6)x58</b>	DBD200Hx42	<b>K215(S)Dx42</b>
DBD47x62	<b>K215(S)Dx62</b>	DBD58x86	<b>Z415(6)x74</b>	DBD200Hx62	<b>K215(S)Dx62</b>
DBD47x82	<b>K215(S)Dx82</b>	DBD58x106	<b>Z415(6)x94</b>	DBD200Hx82	<b>K215(S)Dx82</b>
DBD47x102	<b>K215(S)Dx102</b>	DBD58x126	<b>Z415(6)x110</b>	DBD200Hx102	<b>K215(S)Dx102</b>
DBD47x122	<b>K215(S)Dx122</b>	DBD58x154	<b>Z415(6)x134</b>	DBD200Hx122	<b>K215(S)Dx122</b>
DBD47x182	<b>K215(S)Dx182</b>	DBD58x178	<b>Z415(6)x154</b>	DBD200Hx182	<b>K215(S)Dx182</b>
DBD47x202	<b>K215(S)Dx202</b>	DBD58x198	<b>Z415(6)x174</b>	DBD200Hx202	<b>K215(S)Dx202</b>
DBD47x214	<b>K215(S)Dx214</b>	DBD58x222	<b>Z415(6)x194</b>	DBD200Hx214	<b>K215(S)Dx214</b>
DBD47x222	<b>K215(S)Dx222</b>	DBD58x242	<b>Z415(6)x210</b>	DBD200Hx222	<b>K215(S)Dx222</b>
DBD47, L2=456, W=243, d=2.34 K215(S)D, L2=449, W=247, d=2.40 Max. Plate Number : 222 Max. Working Press. : K215D : 30 bar, K215SD : 45 bar		DBD58, L2=604, W=304, d=2.44 Z415(6), L2=656, W=321, d=2.40 Max. Plate Number : 222 Max. Working Press. : Z415 : 30 bar, Z416 : 45 bar		DBD200H, L2=456, W=243, d=2.29 K215(S)D, L2=449, W=247, d=2.40 Max. Plate Number : 222 Max. Working Press. : K215D : 30 bar, K215SD : 45 bar	

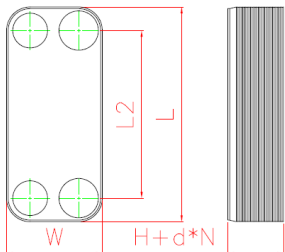

# SWEP DBD300H, DBD310H, DBD400H

DBD300H	<b>Kaori</b>	DBD310H	<b>Kaori</b>	DBD400H	<b>Kaori</b>
DBD300Hx18	<b>K215(S)Dx18</b>	DBD310Hx18	<b>K215(S)Dx18</b>	DBD400Hx22	<b>Z415(6)x18</b>
DBD300Hx28	<b>K215(S)Dx30</b>	DBD310Hx28	<b>K215(S)Dx30</b>	DBD400Hx46	<b>Z415(6)x36</b>
DBD300Hx36	<b>K215(S)Dx38</b>	DBD310Hx36	<b>K215(S)Dx38</b>	DBD400Hx66	<b>Z415(6)x58</b>
DBD300Hx58	<b>K215(S)Dx62</b>	DBD310Hx58	<b>K215(S)Dx62</b>	DBD400Hx86	<b>Z415(6)x74</b>
DBD300Hx76	<b>K215(S)Dx82</b>	DBD310Hx76	<b>K215(S)Dx82</b>	DBD400Hx106	<b>Z415(6)x94</b>
DBD300Hx98	<b>K215(S)Dx106</b>	DBD310Hx98	<b>K215(S)Dx106</b>	DBD400Hx126	<b>Z415(6)x110</b>
DBD300Hx118	<b>K215(S)Dx126</b>	DBD310Hx118	<b>K215(S)Dx126</b>	DBD400Hx154	<b>Z415(6)x134</b>
DBD300Hx136	<b>K215(S)Dx146</b>	DBD310Hx136	<b>K215(S)Dx146</b>	DBD400Hx178	<b>Z415(6)x154</b>
DBD300Hx158	<b>K215(S)Dx170</b>	DBD310Hx158	<b>K215(S)Dx170</b>	DBD400Hx198	<b>Z415(6)x174</b>
DBD300Hx178	<b>K215(S)Dx190</b>	DBD310Hx178	<b>K215(S)Dx190</b>	DBD400Hx222	<b>Z415(6)x194</b>
DBD300Hx202	<b>K215(S)Dx218</b>	DBD310Hx202	<b>K215(S)Dx218</b>	DBD400Hx242	<b>Z415(6)x210</b>
DBD300H, L2=449, W=243, d=1.89 K215(S)D, L2=449, W=247, d=2.40 Max. Plate Number : 222 Max. Working Press. : K215D : 30 bar, K215SD : 45 bar		DBD310H, L2=449, W=243, d=1.91 K215(S)D, L2=449, W=247, d=2.40 Max. Plate Number : 222 Max. Working Press. : K215D : 30 bar, K215SD : 45 bar		DBD400H, L2=604, W=304, d=2.39 Z415(6), L2=656, W=321, d=2.40 Max. Plate Number : 210 Max. Working Press. : Z415 : 30 bar, Z416 : 45 bar	

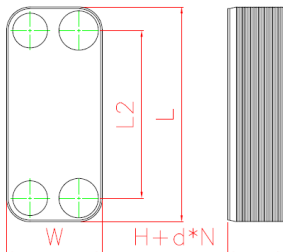



# SWEP DVD47,DVD58,DVD200

DVD47	<b>Kaori</b>	DVD58	<b>Kaori</b>	DVD200	<b>Kaori</b>
DVD47x18	<b>K215(S)Dx18</b>	DVD58x22	<b>Z415(6)x18</b>	DVD200x18	<b>K215(S)Dx18</b>
DVD47x30	<b>K215(S)Dx30</b>	DVD58x46	<b>Z415(6)x36</b>	DVD200x30	<b>K215(S)Dx30</b>
DVD47x42	<b>K215(S)Dx42</b>	DVD58x66	<b>Z415(6)x58</b>	DVD200x42	<b>K215(S)Dx42</b>
DVD47x62	<b>K215(S)Dx62</b>	DVD58x86	<b>Z415(6)x74</b>	DVD200x62	<b>K215(S)Dx62</b>
DVD47x82	<b>K215(S)Dx82</b>	DVD58x106	<b>Z415(6)x94</b>	DVD200x82	<b>K215(S)Dx82</b>
DVD47x102	<b>K215(S)Dx102</b>	DVD58x126	<b>Z415(6)x110</b>	DVD200x102	<b>K215(S)Dx102</b>
DVD47x122	<b>K215(S)Dx122</b>	DVD58x154	<b>Z415(6)x134</b>	DVD200x122	<b>K215(S)Dx122</b>
DVD47x182	<b>K215(S)Dx182</b>	DVD58x178	<b>Z415(6)x154</b>	DVD200x182	<b>K215(S)Dx182</b>
DVD47x202	<b>K215(S)Dx202</b>	DVD58x198	<b>Z415(6)x174</b>	DVD200x202	<b>K215(S)Dx202</b>
DVD47x214	<b>K215(S)Dx214</b>	DVD58x222	<b>Z415(6)x194</b>	DVD200x214	<b>K215(S)Dx214</b>
DVD47x222	<b>K215(S)Dx222</b>	DVD58x242	<b>Z415(6)x210</b>	DVD200x222	<b>K215(S)Dx222</b>
DVD47, L2=456, W=243, d=2.34 K215(S)D, L2=449, W=247, d=2.40 Max. Plate Number : 222 Max. Working Press. : K215D : 30 bar, K215SD : 45 bar		DVD58, L2=604, W=304, d=2.44 Z415(6), L2=656, W=321, d=2.40 Max. Plate Number : 222 Max. Working Press. : Z415 : 30 bar, Z416 : 45 bar		DBD200, L2=456, W=243, d=2.29 K215(S)D, L2=449, W=247, d=2.40 Max. Plate Number : 222 Max. Working Press. : K215D : 30 bar, K215SD : 45 bar	

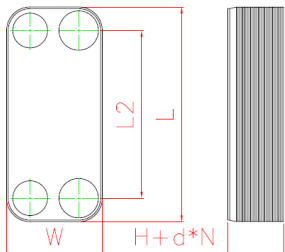

# SWEP DVD300H, DVD400H

DVD300H	<b>Kaori</b>	DVD400H	<b>Kaori</b>		
DvD300Hx18	<b>K215(S)Dx18</b>	DVD400Hx22	<b>Z415(6)x18</b>		
DVD300Hx28	<b>K215(S)Dx30</b>	DVD400Hx46	<b>Z415(6)x36</b>		
DVD300Hx36	<b>K215(S)Dx38</b>	DVD400Hx66	<b>Z415(6)x58</b>		
DVD300Hx58	<b>K215(S)Dx62</b>	DVD400Hx86	<b>Z415(6)x74</b>		
DVD300Hx76	<b>K215(S)Dx82</b>	DVD400Hx106	<b>Z415(6)x94</b>		
DVD300Hx98	<b>K215(S)Dx106</b>	DVD400Hx126	<b>Z415(6)x110</b>		
DVD300Hx118	<b>K215(S)Dx126</b>	DVD400Hx154	<b>Z415(6)x134</b>		
DVD300Hx136	<b>K215(S)Dx146</b>	DVD400Hx178	<b>Z415(6)x154</b>		
DVD300Hx158	<b>K215(S)Dx170</b>	DVD400Hx198	<b>Z415(6)x174</b>		
DVD300Hx178	<b>K215(S)Dx190</b>	DVD400Hx222	<b>Z415(6)x194</b>		
DVD300Hx202	<b>K215(S)Dx218</b>	DVD400Hx242	<b>Z415(6)x210</b>		
DVD300H, L2=449, W=243, d=1.89 K215(S)D, L2=449, W=247, d=2.40 Max. Plate Number : 222 Max. Working Press. : K215D : 30 bar, K215SD : 45 bar		DVD400H, L2=604, W=304, d=2.39 Z415(6), L2=656, W=321, d=2.40 Max. Plate Number : 210 Max. Working Press. : Z415 : 30 bar, Z416 : 45 bar			

